

| You are in: Lozier > Products > Crosstube Arms

Crosstube Arms

Part Number: XTA

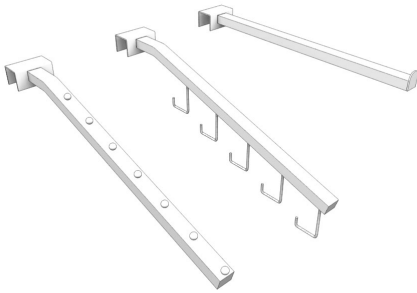

Crosstube Arms fit Crosstubes and are available in three styles: Straight, 7-Ball Downslant, and 5-Hook Downslant. All three styles project 12" from Crosstube.

Product Details:

- 0.830" square tube
- Fits on 1" square Crosstube
- Use on 1" projection Crosstube only
- Three styles of Arms:
 1. Straight
 2. 7-Ball Downslant
 3. 5-Hook Downslant
- All styles project 12" from Crosstube

How to Order

Straight Crosstube Arm

Product Options and Numbers

Part #: [XTAS12](#) [PCP](#)

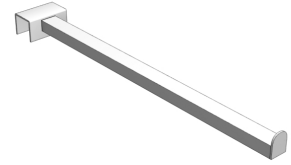

Straight Crosstube Arm: [XTAS12](#)

Standard Finish: [PCP](#)

Suffix Key

[PCP](#) - Polished Chrome Plated

7-Ball, Downslant Crosstube Arm

Product Options and Numbers

Part #: [XTA7BD12](#) [PCP](#)

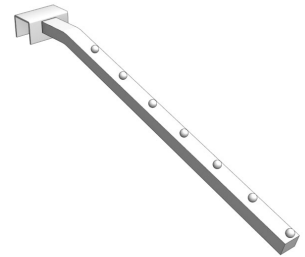

7-Ball, Downslant Crosstube Arm: [XTA7BD12](#)

Standard Finish: [PCP](#)

Suffix Key

[PCP](#) - Polished Chrome Plated

5-Hook, Downslant Crosstube Arm

Product Options and Numbers

Part #: [XTA5HD12](#) [PCP](#)

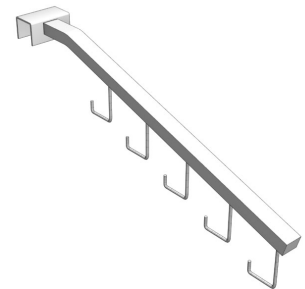

5-Hook, Downslant Crosstube Arm: [XTA5HD12](#)

Standard Finish: [PCP](#)

Suffix Key

PCP

- Polished Chrome Plated