

| You are in: [Lozier](#) > [Products](#) > [Full Height Wing to End Frame & End Deck Accessory Panel Connectors](#)

Full Height Wing to End Frame & End Deck Accessory Panel Connectors

Part Number: **Part Number: AP**

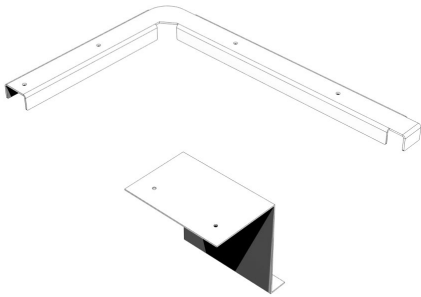

Accessory Panel Connectors are required when using Accessory Panels with standard End Solutions. Order Connector type based on the desired application of your Accessory Panels.

Product Details:

- Accessory Panel Connectors are needed to attach Accessory Panels to Wall or Contoured End Display, End Merchandising Panels and Close Off Panel
- Order when installing a Full Height Accessory Panel (FHAP) to an End Deck/Flush Merchandising Panel (FMP) End Display
- See Installation Instructions for load capacities and limitations

INCLUDES

- Upper Connector
- Lower Base Support
- Hardware Pack

Product Options and Numbers

Example Part #: **AP 16 R 06 PLT**

Full Height Wing to End Frame & End Deck
Accessory Panel Connectors: AP

Width: 14", **16"**, 18", 24", 30", 36"

Flush Position: L, **R**

Base Type: **06**, LB

Standard Finish: **PLT**, Optional Catalog Colors

Suffix Key

L	- Flush Left
R	- Flush Right
06	- 06 Base (8"H)
LB	- Low Base (6"H)
PLT	- Platinum