

| You are in: [Lozier](#) > [Products](#) > [Wing on Base End Trim Flush Accessory Panel Connectors](#)

# Wing on Base End Trim Flush Accessory Panel Connectors

Part Number: **Part Number: APW**

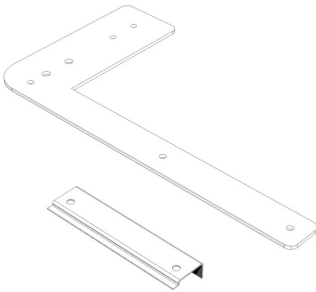

Accessory Panel Connectors are required when using Accessory Panels with standard End Solutions. Order Connector type based on the desired application of your Accessory Panels.

## Product Details:

- For applications to the Wall End Display Base End Trim
- A Wall End Display Rail (WEDER) is required, order separately
- See Installation Instructions for load capacities and limitations

## INCLUDES

- Upper Connector
- Base Angle
- Hardware Pack

## Product Options and Numbers

---

Example Part #: **APW** **PLT** **CHR**

**Wing on Base End Trim Accessory Panel Connectors:**  
**APW**

**Upper Connector Standard Finish:** **PLT**, Optional  
Catalog Colors

**Lower Connector Standard Finish:** **CHR**, Optional  
Catalog Colors

Please view Optional Catalog Colors and Contact Product Management for respective multiple finish code.

Suffix Key	
<b>PLT</b>	- Platinum
<b>CHR</b>	- Charcoal Black