

| You are in: [Lozier](#) > [Products](#) > [Versa with Wire Wing Panels](#)

Versa with Wire Wing Panels

Part Number:

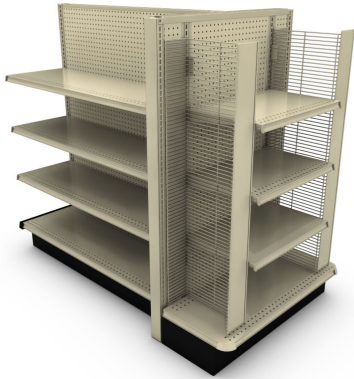

Create multiple End Cap configurations through the flexibility of Versa shelving components. Add promotional wing panels extend merchandising opportunities without intruding into the aisle.

Product Details:

How to Order

This End Cap features a combination of Lozier Products. See below for details.

Contoured End Display

- Same as Wall End Display, except uses Contoured End Decks, Contoured End Shelves, and Contoured Base Bracket End Trims
- Order Shelves separately
- Order Gap Filler separately when unit is wider than Island
- Actual width of unit equals nominal width plus 2"
- Base End Trim and Closed Base Front available in CHR only



TO ORDER OTHER BACK STYLES

- Delete the Peg Front and/or Marteck Rear Back(s) and replace with the desired Back(s)
- If Slotwall Backs desired, order required Rails

TO ORDER DECKS WITH ALUMINUM MOLDING

- Delete Standard Deck and add Deck with Molding

Product Options and Numbers

Example Part #: **CED 4 60 22 06 S P M PLT PLT PLT**

Contoured End Display: **CED**

Unit Width: 2', 30", 3', **4'**

Upright Height: 48", 54", **60"**, 66", 72", 78", 84", 90", 96"

Base Deck Depth: 13", 16", 19", **22"**, 25"

Base Height: **06**, LB

Spring Locking Base Bracket: **S**

Front Back Style: **P**

Rear Back Style: **M**

Uprights and Upright Trim Standard Finish: **PLT**, Optional Catalog Colors

Back and Rail Standard Finish: **PLT**, Optional Catalog Colors

Deck Standard Finish: **PLT**, Optional Catalog Colors

Suffix Key

LB - Low Base (6"H)

- 06** - 06 Base (8"H)
- P** - Pegboard Back
- M** - Marteck Back
- PLT** - Platinum

CED SIZES									
Depth	Height								
	48"	54"	60"	66"	72"	78"	84"	90"	96"
13"			N/A	N/A	N/A	N/A	N/A	N/A	N/A
16"						N/A	N/A	N/A	N/A
19"									N/A
22"									
25"									

Versa System

HIGHLIGHTS

- Converts existing sections into multiple width sections
- Works with standard or heavy duty systems
- Accepts most standard Lozier Shelves and Accessories
- Order Heavy Duty Versa when existing section is Heavy Duty
- Versa Half Splicer ordered separately as needed to splice Hardboard Backs
- Backs must be ordered separately
- Regular and Heavy Duty Versa supports standard load capacity of a 48"W system - 12,000 in-lbs

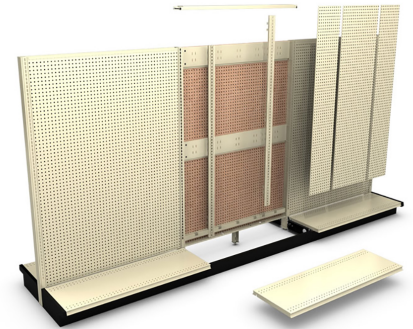

INCLUDES

- Versa Uprite
- Versa Spanners
- Versa Top Rail
- Half Splicer Rail (where applicable)
- Versa Bottom Spanner
- Bottom Rail Support

VERSA SYSTEM CONFIGURATIONS

- Available 36"H to 96"H
- If using Versa Slotwall, can use on Versa side only. Slotwall is not compatible on backside of Versa Section
- Order Versa Half Splicer for Hardboard Backs on Sections 78"H and taller
- See STD Hardboard Backs for ordering information
- See Versa Slotwall VBE Backs for ordering information

VERSA SYSTEM 4' CONFIGURATIONS

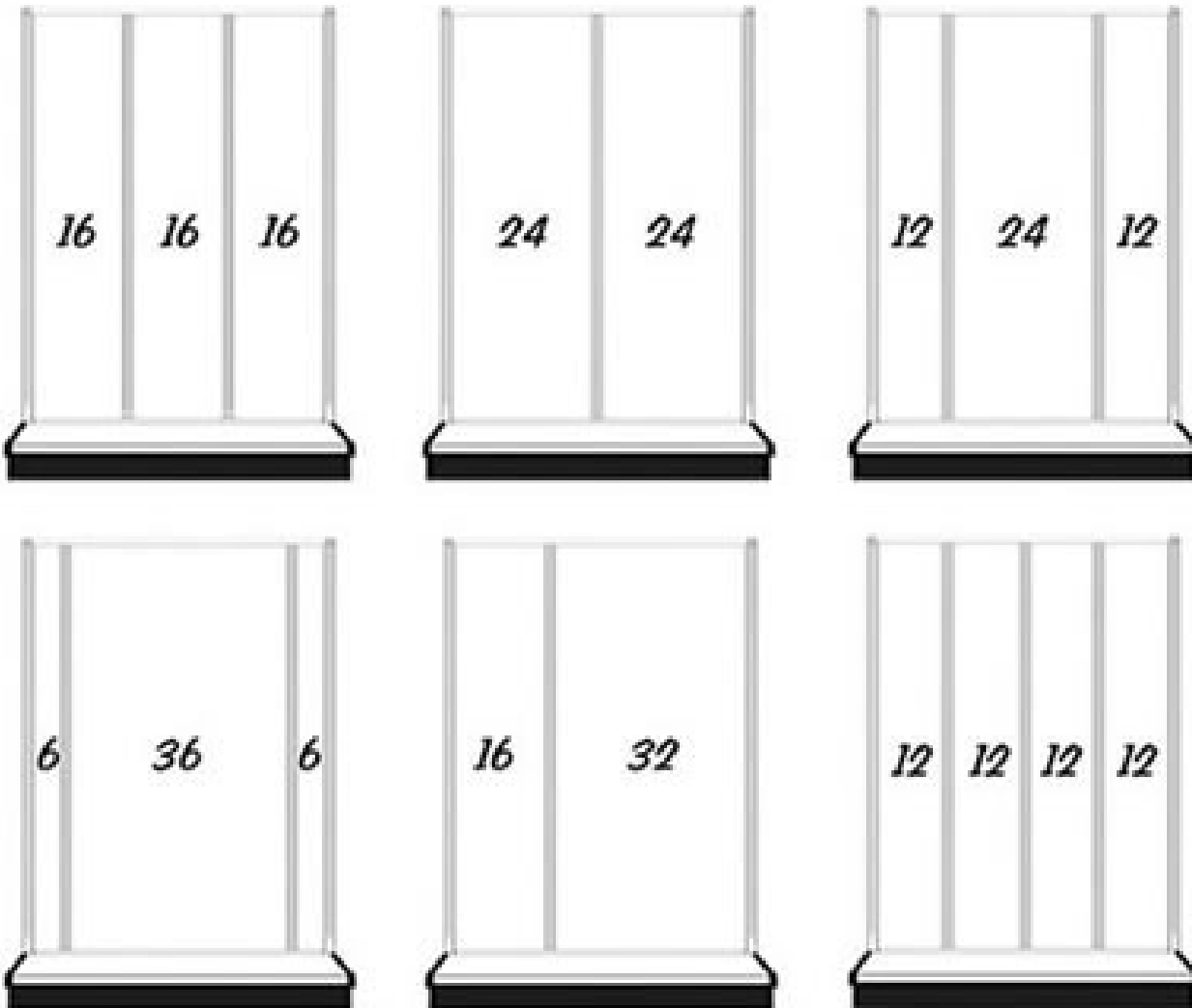

VERSA SYSTEM 3' CONFIGURATIONS

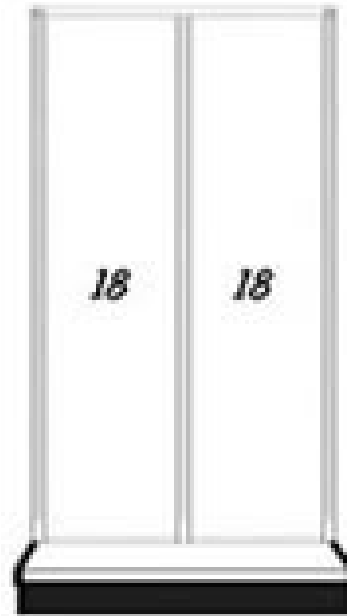
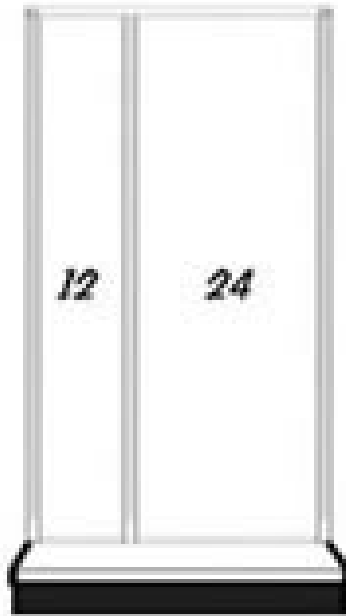

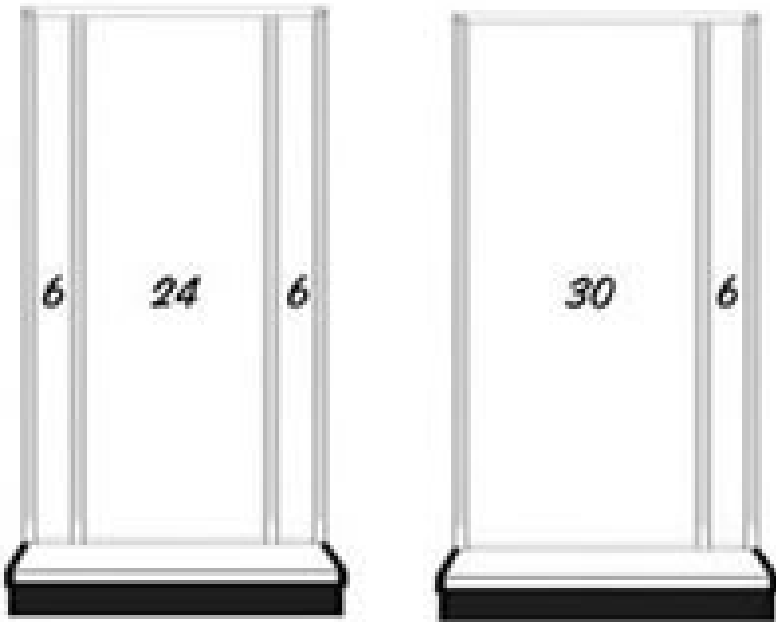

Product Options and Numbers

Example Part #: **VS 4 54 3 H H PLT PTD PLT PLT**

Versa System: **VS**,VSH

Section Width:3', **4'**

Section Height:36", 42", 48", **54"**, 60", 66", 72", 78", 84", 90", 96"

Quantity of Versa Sections:2,**3**,4

Spanner Style: **H**,S

Opposite Back Style: **H**,Omit if other

Upright Standard Finish: **PLT**,Optional Catalog Colors

Spanner Standard Finish: **PTD**

Side A Rail Standard Finish:**PLT**,Optional Catalog Colors

Side B Rail Standard Finish: **PLT**,Optional Catalog Colors

Side B Rail Finish only required for sections 78"H or taller and with Hardboard selected on the opposite side.

Suffix Key

VS - Versa System to fit Standard Duty

VSH	- Versa System to fit Heavy Duty
H	- Hardboard
S	- Slotwall
PLT	- Platinum
PTD	- Painted Random

Wire Wing Panels

- 48"H x 14"W x 5"D
- Fully wrapped wings
- Wires are spaced on 27/32" centers, accepts crossbar and 1" grid hooks
- Two mounting methods available:
 - Welded Upright Mounting Brackets: Mounts on left or right side with no loose hardware (recommend using shelf behind)
 - J-Mount Attachment Clips: Mounts direct to two shelves (two clips included)
- When used with EMPs, Wire Wing Panel Bracket cannot be in the same Upright slot as Shelf Bracket. J-Mount Clip must be used for stability and can only be used with a flat position Shelf
- CANNOT be used with Contoured End Shelves

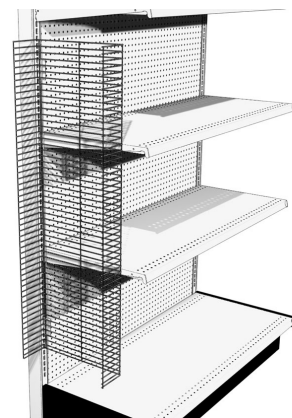

Product Options and Numbers

Example Part #: **WWP 48 14 WB PLT**

Wire Wing Panel: **WWP**

Height: **48"**

Width: **14"**

Welded Upright Mount Bracket: **WB**, Leave blank for J-Clip

Standard Finish: **PLT**, Optional QP3, Optional Catalog Colors

Suffix Key

PLT - Platinum

Vertical Sign Channel for Wire Wing Panels

Contact your Sales Rep for ordering Information

Product Options and Numbers

Part #: **DF499_**



TL Shelf

- Two position tilt-in Shelf with extended bracket
- Angular adjustment: flat or 17° downslope
- Molding accommodates a 1.235" tag
- 1/4" perforations for clip-on accessories
- Can order with Aluminum Tag Moldings installed or can order Molding for Shelf separately

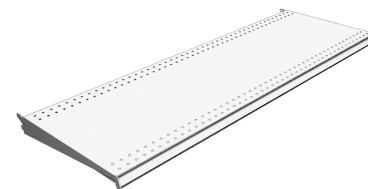

Product Options and Numbers

Example Part #: **TL 4 19 N PLT**

TL Shelf: **TL**

Width: 2', 30", 3', **4'**

Depth: 7", 10", 13", 15", 16", 17", **19"**, 20", 22", 25", 28", 31"

Molding: **N**, M13S, M35S

Standard Finish: **PLT**, Optional Catalog Colors

Suffix Key

N	- No Molding
M13S	- M13 Satin Molding

M35S - M35 Satin Molding

PLT - Platinum

Shelf Depth	Downslope	
	Flat	17°
7"	300 lbs	300 lbs
10" - 25"	500 lbs	250 lbs
28" & 31"	400 lbs	200 lbs

Lbs. evenly distributed

DL Shelf

- Three position, drop-in shelf with extended bracket
- Angular adjustment: flat, 17° or 30° downslope
- 1/4" perforations for clip-on accessories
- Can order with Aluminum Tag Moldings or can order Molding for shelf separately

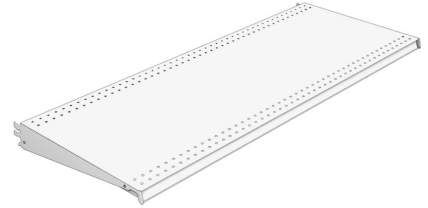

Product Options and Numbers

Example Part #: **DL 4 19 N PLT**

DL Shelf: **DL**

Width: 2', 30", 3', **4'**

Depth: 7", 10", 13", 15", 16", 17", **19"**, 20", 22", 25", 28", 31"

Molding: **N**, M13S, M35S

Standard Finish: **PLT**, Optional Catalog Colors

Suffix Key

- N** - No Molding
- M13S** - M13 Satin Molding
- M35S** - M35 Satin Molding
- PLT** - Platinum

Shelf Depth	Downslope
-------------	-----------

Flat	17°	30°	
7"	300 lbs	300 lbs	125 lbs
10" - 19"	500 lbs	250 lbs	250 lbs
20" - 25"	500 lbs	250 lbs	125 lbs
28" & 31"	400 lbs	200 lbs	100 lbs

Lbs. evenly distributed.