

| You are in: [Lozier](#) > [Products](#) > [Bottom Rail](#)

Bottom Rail

Part Number: R

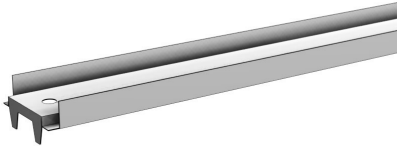

Product Details:

- All Island and Wall Sections require one Top, Center and Bottom Rail
- Electrical knockouts included on all Rails
- Also used for 2' and 30" Slotwall Backs

Product Options and Numbers

Example Part #: **R 4 B PLT**

Rails: R

Width: 2', 30", 3', 4'

Bottom Rail: B

Standard Finish: PLT, Optional Catalog Colors

Suffix Key

PLT

- Platinum Color