

| You are in: Lozier > Products > Pallet Rack

# Pallet Rack

Part Number: **LPR**



Use Pallet Rack for Heavy Duty Applications. Our Pallet Rack system contains four basic parts: Upright Frames, Beams, Shelf or Pallet Supports, and Wood or Wire Decks.

## Product Details:

- Heavy Duty Applications

## COMPONENTS

- Upright Frames
- Beams
- Shelf or Pallet Supports
- Wood or Wire Decks

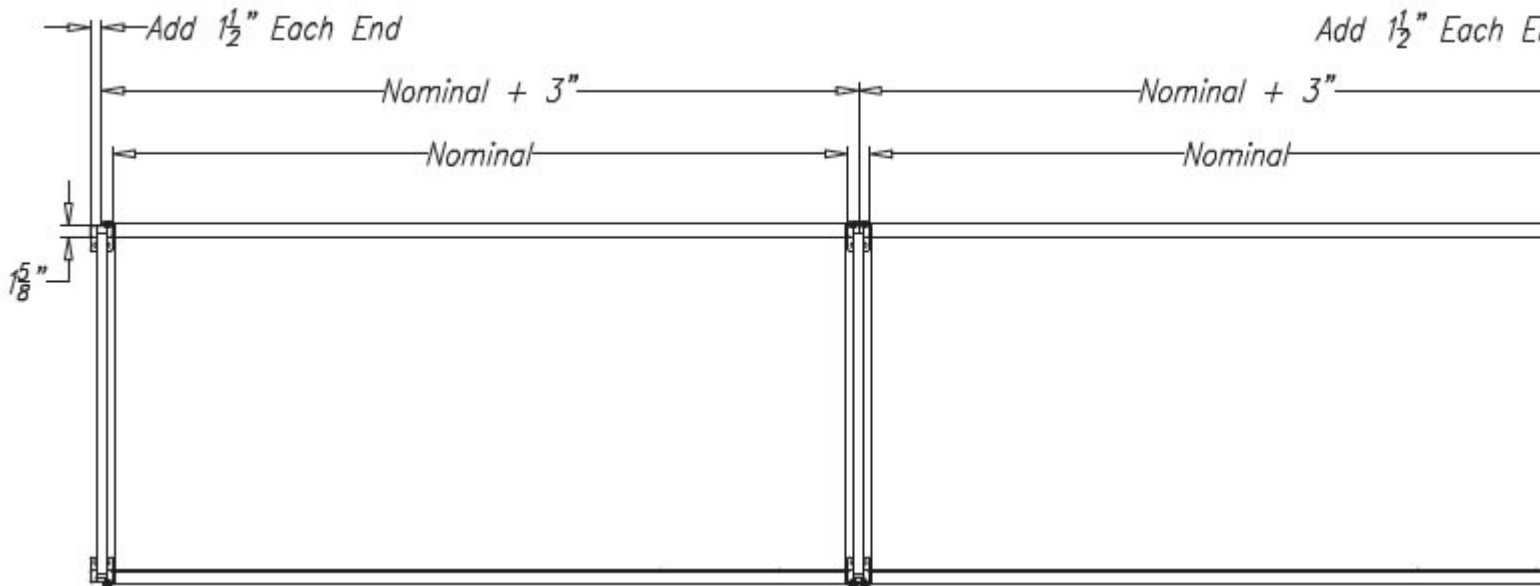

## How to Order

---

### Pallet Rack Upright

---

- Keyhole slotting is 2" on center for beam adjustability
- Features one-piece welded construction
- Depths: 24"-48"
- Heights: 48"-144"
- Posts have 1 5/8" x 3" cross-sectional dimensions
- Requires floor anchoring
- Hardware not included
- Evenly distributed load of 17,000 lbs per Upright Frame at 48" maximum vertical beam spacing



### Product Options and Numbers

Example Part #: **LPRU 24 048 S PLT**

**Lozier Pallet Rack Upright: LPRU**

**Section Depth:** 24", 36", 42", 48"

**Upright Height:** 048", 072", 096", 120", 144"

**System:** S

**Pallet Rack Upright Standard Finish:** PLT

Suffix Key	
PLT	- Platinum

**Pallet Rack Beams**

- Available in multiple lengths and capacities
- Features a 7/8" deep step with slots for positive shelf support location
- End clips have three heavy duty studs and a spring locking mechanism on the Beam clip
- Nominal lengths correspond with the opening between Upright frames

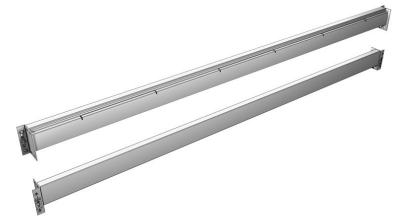

**PALLET RACK BEAM LOADING EXAMPLE**

Beams will be 8 ft. long and require a 6,000lb load capacity per pair. An excerpt from the beam capacity chart shows that the Pallet Rack run will require a 96" long beam with a height of 4.5 inches. Always select a beam with capacities equal to or greater than planned loading.

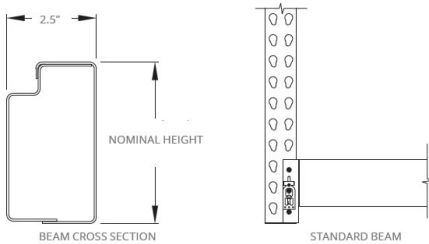

( Beam capacities based on even weight distribution )		
Length	Height	Capacity Pair (lbs)
48"	4.5"	10,000
	6.0"	16,000
96"	4.5"	6,000
	6.0"	9,000
99"	4.5"	5,300

108"		
	6.0"	8,000

## Product Options and Numbers

Example Part #: **LPRB 048 45 PLT**

Pallet Rack Beams: **LPRB**

Length: **048"**, 096", 099", 108"

Height: **45**, 60

Standard Finish: **PLT**

Suffix Key	
<b>PLT</b>	- Platinum
<b>45</b>	- 4.5" High
<b>60</b>	- 6.0" High

## Pallet Rack Shelf Support

---

- Features an "I" beam design which hooks into slots in the Pallet Rack Beams
- Required for all applications requiring load bearing shelves
- Nominal lengths correspond to nominal depths of conventional Pallet Rack Uprites

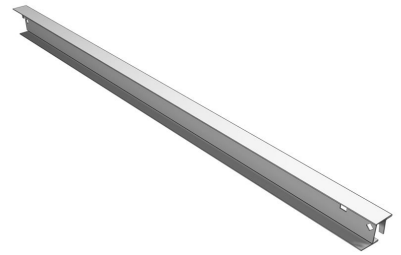

## PALLET RACK SHELF SUPPORT LOADING

Shelf Supports (in conjunction with particleboard shelves) are required when levels are hand loaded or when palletized loads do not rest on front and back beams (or when pallets do not have sufficient strength to support the load in this fashion.) As shown by the shelf support chart excerpt, 6 supports per level are required to achieve the 6,000 lb load capacity. If pallets rest on beams, as few as 2 shelf supports could be used.

## Product Options and Numbers

Example Part #: **LPRSS 24 PLT**

Pallet Rack Shelf Support: **LPRSS**

Length: **24"**, 36", 42", 48"

Standard Finish: **PLT**

### Suffix Key

**PLT**

- Platinum

Available Capacity on Flat Wire Decking or Particleboard Using the Number of Pallet Rack Supports Included

**NOTE: The rated load capacity per pair of beams must be equal to or exceed the rated shelf capacity**

Frame Depth	Beam Length	# Of Supports			Frame Depth	Beam Length	# Of Supports			Frame Depth	Beam Length	# Of Supports		
		2	4	6			2	4	6			2	4	6
24"	48"	2400 lbs	4800 lbs		36"	48"	2400 lbs	4800 lbs		48"	48"	2000 lbs	4000 lbs	
	96"	2400 lbs	4800 lbs	7200 lbs		96"	2400 lbs	4800 lbs	7200 lbs		96"	2000 lbs	4000 lbs	6000 lbs
	99"		4800 lbs	7200 lbs		99"		4800 lbs	7200 lbs		99"		4000 lbs	6000 lbs
	108"			7200 lbs		108"			7200 lbs		108"			6000 lbs

					42"	48"	2400 lbs	4800 lbs						
						96"	2400 lbs	4800 lbs	7200 lbs					
						99"		4800 lbs	7200 lbs					
						108"			7200 lbs					
All Load Capacities Based on a Static Evenly Distributed Load														

## Pallet Rack Pallet Support

- Features a flanged end design which wraps over the step beam and provides a support height flush with the beam top
- Suitable for supporting pallets on rack levels which do not require particleboard Shelves
- Two Pallet Supports are required per pallet
- Nominal lengths of Pallet Supports correspond to nominal depths of conventional Pallet Rack Uprights



## Product Options and Numbers

Example Part #: **LPRPS 24 PLT**

Pallet Rack Pallet Support: **LPRPS**

Length: **24"**, 36", 42", 48"

Standard Finish: **PLT**

### Suffix Key

**PLT** - Platinum

## Pallet Rack Particleboard Decking

- Economical shelving material
- Features 5/8" thick, industrial grade particleboard



Nominal		Actual Dimensions
Length	Depth	
48"	24"	20 5/16" x 45 1/4"
	36"	32 5/16" x 45 1/4"
	42"	38 5/16" x 45 1/4"
	48"	44 5/16" x 45 1/4"
96"	24"	20 5/16" x 93 1/4"
	36"	32 5/16" x 93 1/4"
	42"	38 5/16" x 93 1/4"
	48"	44 5/16" x 93 1/4"
99"	24"	20 5/16" x 96 1/4"
	36"	32 5/16" x 96 1/4"
	42"	38 5/16" x 96 1/4"
	48"	44 5/16" x 96 1/4"
108"	24"	20 5/16" x 105 1/4"
	36"	32 5/16" x 105 1/4"
	42"	38 5/16" x 105 1/4"
	48"	44 5/16" x 105 1/4"

**NOTE:**

Nominal size corresponds to the depth of Pallet Rack Upright Frame and the length of the Pallet Rack Beam.

## Product Options and Numbers

Example Part #: **LPRPB 24 48 N/A**

**Pallet Rack Particleboard Decking: LPRPB**

**Section Depth:** 24", 36", 42", 48"

**Deck Width:** 48", 96", 99", 108"

**Standard Finish:** N/A

### Suffix Key

N/A

- No Finish

## Pallet Rack Flat Wire Decking

---

- Provides for: light penetration, water flow through for sprinklers and cleanliness
- Each grid is one- piece, 3" x 3" pattern, with 5/16" diameter width wires and 1/4" diameter depth wires
- Clearances are provided for easy installation
- Order Shelf Supports separately

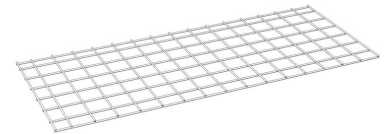

## Product Options and Numbers

Example Part #: **LPRWDF 24 48 ZNC**

**Pallet Rack Flat Wire Decking: LPRWDF**

**Section Depth:** 24", 36", 42", 48"

**Deck Width:** 48", 96", 99", 108"



Standard Finish: **ZNC**

Suffix Key

**ZNC** - Zinc Plated Wire

Nominal		Actual Dimensions
Length	Depth	
48"	24"	20 5/16" x 45 1/4"
	36"	32 5/16" x 45 1/4"
	42"	38 5/16" x 45 1/4"
	48"	44 5/16" x 45 1/4"
96"	24"	20 5/16" x 93 1/4"
	36"	32 5/16" x 93 1/4"
	42"	38 5/16" x 93 1/4"
	48"	44 5/16" x 93 1/4"
99"	24"	20 5/16" x 96 1/4"
	36"	32 5/16" x 96 1/4"
	42"	38 5/16" x 96 1/4"
	48"	44 5/16" x 96 1/4"
108"	24"	20 5/16" x 105 1/4"
	36"	32 5/16" x 105 1/4"
	42"	38 5/16" x 105 1/4"
	48"	44 5/16" x 105 1/4"

**Note:** Nominal size corresponds to the depth of Pallet Rack Upright Frame and the length of the Pallet Rack Beam.