

| You are in: [Lozier](#) > [Products](#) > [S-Series Storage Screw](#)

# S-Series Storage Screw

Part Number: **Part Number: SS2221**

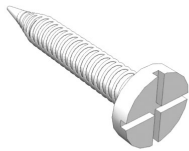

S Series Storage Screw is used to connect two Open Upright Assemblies, and to fasten Back Panels to Upright Assemblies.

## Product Details:

- #8 x 3/4" Phillips head sheet metal screws
- Connect two open S-Series Storage Upright Assemblies through the pilot holes punched in the Upright post face to create a double-entry island
- May also be used to attach Back Panels to Upright Assemblies

Assembly Height	# of Screws Required to Connect Uprights
36" - 72"	2
84" - 108"	3
120" - 144"	4

## Product Options and Numbers

---

Part #: **SS2221** N/A

S-Series Back-to-Back Screw: **SS2221**

Standard Finish: **N/A**

Suffix Key	
N/A	- No Finish