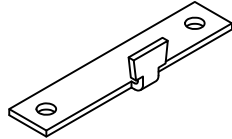


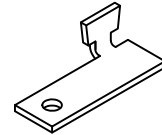
# INSTALLATION INSTRUCTIONS

## WALL MOUNT BRACKET

Load Rating: Center Wall Mount Bracket is rated to 12,000 in-lbs. End Wall Mount Bracket is rated to 6,000 in-lbs. This load rating is contingent upon and may be lowered due to the structural integrity of the wall being anchored to and the methods of fastening used. The purchaser of the fixture is responsible for determining the suitability of any specific wall or structure to which shelving is anchored, for the selection of and/or proper installation of the anchoring fasteners, hardware and materials, and for the workmanship of those performing anchoring. These guidelines are meant to illustrate typical types of anchoring and do not constitute any endorsement by Lozier of any specific anchoring application. Each application will vary due to the building, structure and materials used for anchoring, and professional advice should be sought for each anchored installation.



**CENTER WALL MOUNT BRACKET**



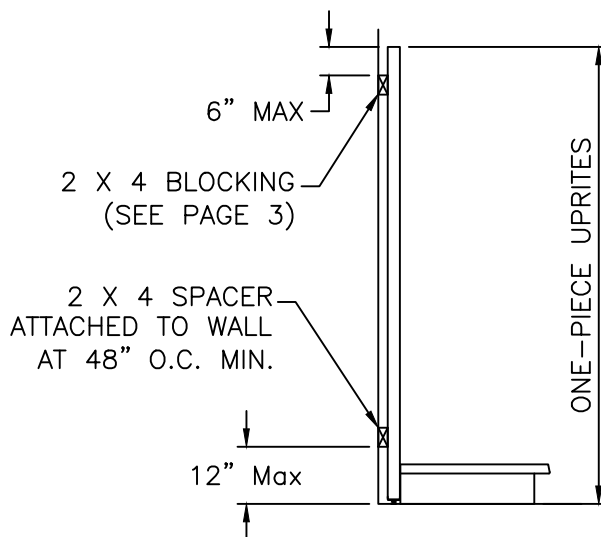
**END WALL MOUNT BRACKET**

As a guideline, each anchoring location shown must provide a minimum of 450 pounds of pull-out resistance and be located as shown in these illustrations. Extreme care must be taken to insure that the building wall or other structure is solid and suitable for anchoring and will support the load being anchored to it. Anchoring situations other than those illustrated may be encountered.

For Wall Sections with base brackets install properly, anchors may also be used to limit deflection under loaded conditions. In these cases, the wall anchors do NOT provide any additional load capacity. The load capacity of the anchored system remains that of the base system capacity prior to anchoring. The anchoring is simply in place to help limit deflection of the system under load.

**CAUTION: DO NOT USE PLASTIC OR FIBER ANCHORS, CONCRETE NAILS, OR REGULAR NAILS.**

**CAUTION: DO NOT OVERTIGHTEN FASTENERS. OVERTIGHTENING CAN CAUSE MATERIAL DAMAGE OR THREAD DAMAGE, CAN WEAKEN THE CONNECTION, AND COULD CAUSE THE PRODUCT TO COLLAPSE CAUSING BODILY INJURY OR PROPERTY DAMAGE.**

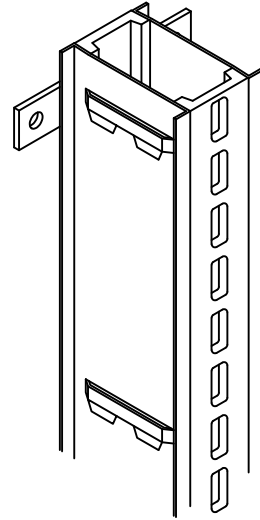
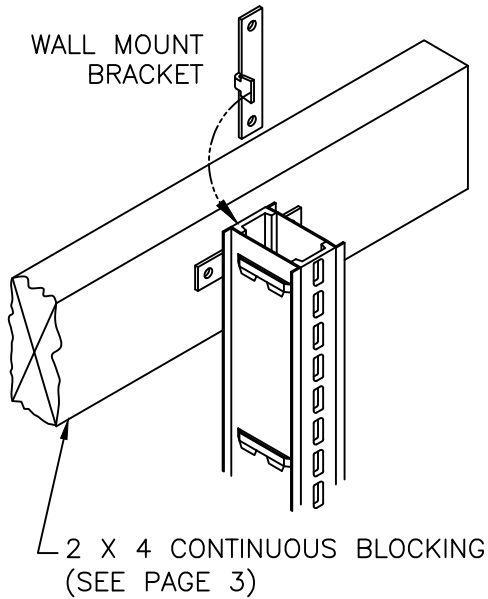


**SINGLE LEVEL BLOCKING**

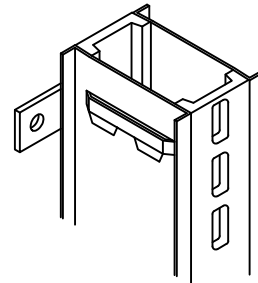
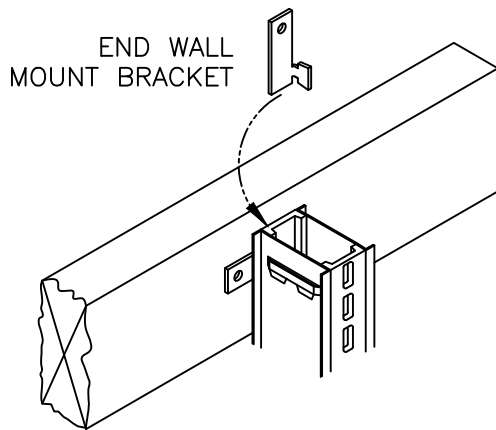
# INSTALLATION INSTRUCTIONS

## WALL MOUNT BRACKET

Rotate Wall Mount Bracket into Upright Face Channel. (See FIGURE 2).  
Attach Wall Mount Bracket to 2 x 4 Blocking.

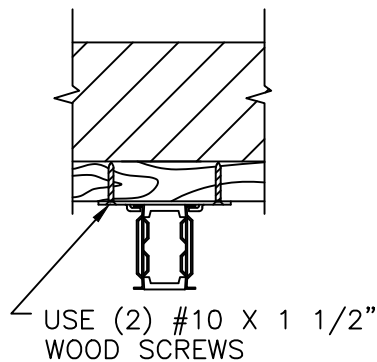


**FIGURE 2**



**FIGURE 2**  
**CENTER AND END BRACKETS**

NOTE: All fasteners shown are minimum diameter and length for applications illustrated.



**ALL TYPES OF WALL  
WITH CONTINUOUS BLOCKING**

# INSTALLATION INSTRUCTIONS

## WALL MOUNT BRACKET

**NOTE:** All fasteners shown are minimum diameter and length for applications illustrated.

### ATTACHING BLOCKING TO WALL

